

Remote Control Instructions

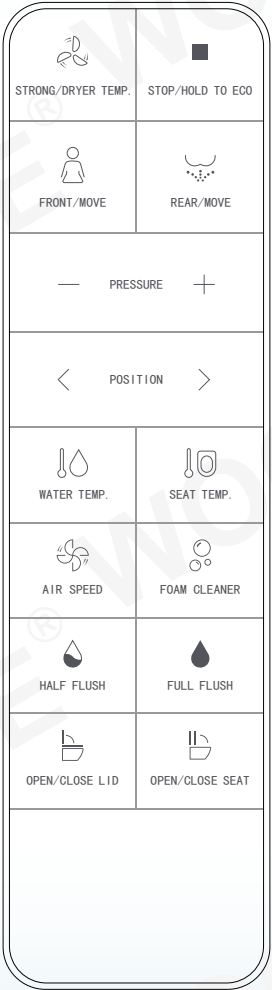

Thank you for choosing our product. Please read the instructions carefully before installation and keep it available for future maintenance or reference.

Content

Installation preparation

01. Remote control installation _____ 02

02. Battery installation _____ 02

Usage instruction

01. Remote control illustration _____ 03

02. Rear/Front washing _____ 04

03. Strong/Dryer temperature _____ 05

04. Water volume adjustment _____ 05

05. Nozzle position adjustment _____ 05

06. Energy saving _____ 05

07. Water temperature adjustment _____ 06

08. Seat temperature adjustment _____ 06

09. Drying air speed adjustment _____ 06

10. Full flush/Half flush _____ 06

11. Foam setting _____ 07

12. Auto lid open/close _____ 07

13. User code _____ 07

14. Other operations _____ 08

Installation Preparation

Remote control installation

Remote control holder installation 1:

1. Drill two 6mm diameter holes in the wall at a distance of about 115mm, a depth of about 35mm.
2. Remove the double-sided adhesive tape on the back of the holder.
3. Install an anchor into the hole, stick the holder to the wall and secure with screws and then stick the patch with tape.

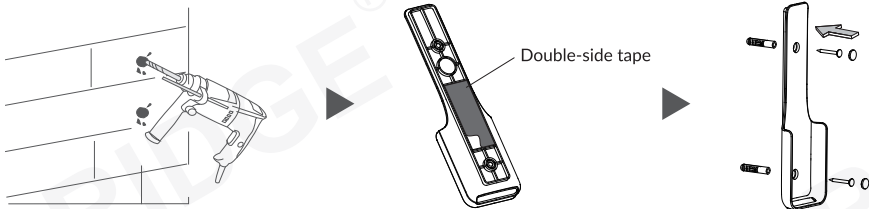

Remote control holder installation 2:

1. Clean and dry the pre-installation area of the holder.
2. Remove the double-sided adhesive tape on the back of the holder.
3. Stick the holder to the wall vertically and then stick the patch with tape.

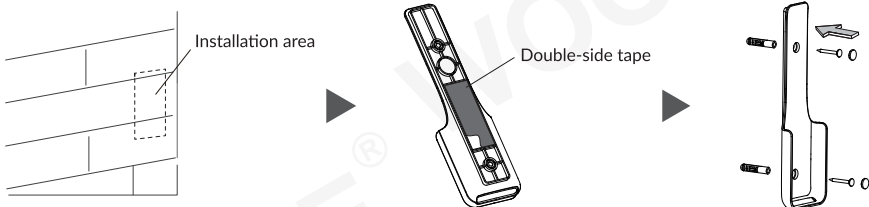

Battery installation:

1. Insert batteries into the remote control.
2. Put the remote control to the holder.

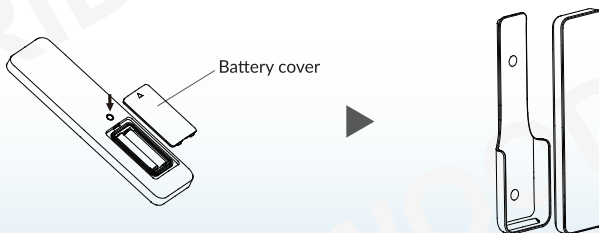

Notice:

1. Please ensure the remote control is within reach when a person on the seat.
2. Do not install and use the product in damp places such as a shower room.
3. Do not place the product in a place where it is easily exposed to water.

Installation Preparation

Remote control illustration

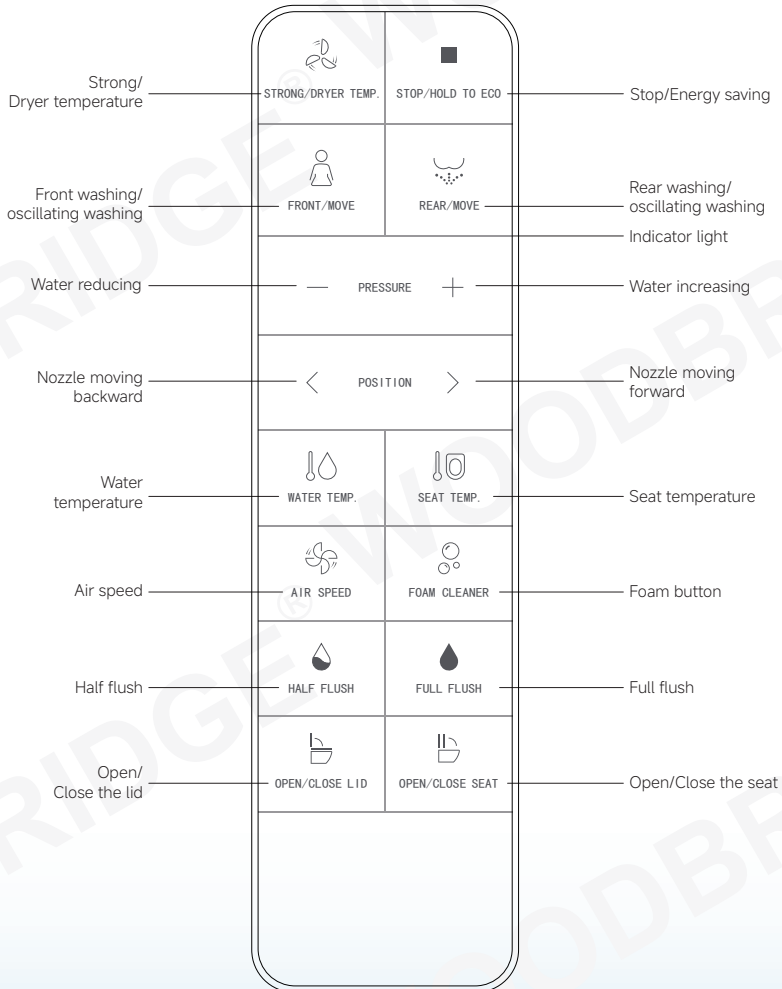

Usage Instruction

Notice :

- Only when the user is seated and the buzzer beeps can the functions of front/rear washing and drying be activated.
- Please sit backward on the seat for correct washing position and to avoid splashing.
- The nozzle will continue to spray for 1-2 seconds after user stands up during washing, so please press "STOP" button before standing up.

REAR|MOVE



- Press " " button, the indicator light is on showing current water temperature level, it starts rear washing; Press again " " button to shift to oscillating washing (nozzle moves forward and backward to expand washing area). The washing will stop automatically after one cycle, while it will stop immediately if the user presses " ■ " button.

FRONT|MOVE



- Press " " button, the indicator light is on showing current water temperature level, it starts front washing; Press again " " button to shift to oscillating washing (nozzle moves forward and backward to expand washing area). The washing will stop automatically after one cycle, while it will stop immediately if the user presses " ■ " button.

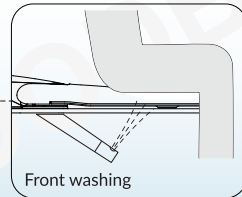
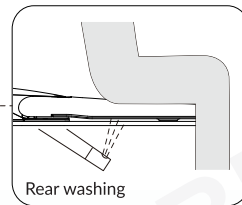
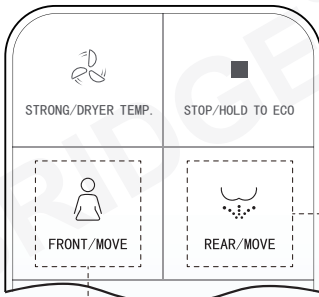

Usage Instruction

STRONG | DRYER TEMP



① Press "  " button, the indicator is on showing current air temperature gear, it starts drying. The drying will stop automatically after one cycle or after user leaves the seat.

② Under drying, press "  " button to adjust the air temperature, and the indicator light is on showing the air temperature gear.

When the indicator light is off, the temperature is at gear 0 (room temperature),

The air temperature adjustment mode is cycle through 0-5 gears.

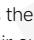
③ Under drying, press the air outlet position "  ", "  " button, the indicator light is on showing the current air outlet gear, and the air outlet position can be adjusted between 0-5 gears.

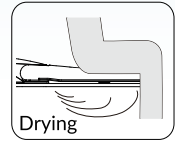

Water volume adjustment

- Press "+" or "-" button when it is under function of rear washing or front washing, the indicator light is on showing current water volume level, and water volume can be adjusted.

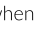
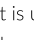

Nozzle position adjustment

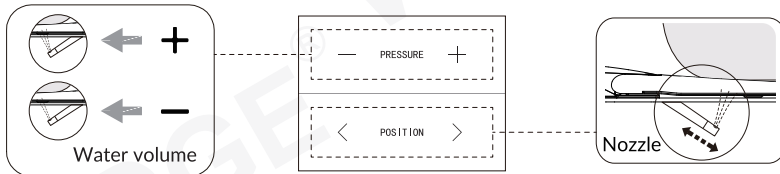
- Press "  " or "  " button when it is under function of rear washing or front washing, the indicator light is on showing current nozzle position, and nozzle position can be adjusted in 5 levels.



Energy saving



Long press "  " button to enter energy saving mode, long press "  " button again to exit energy saving mode.

Under energy saving mode, seat temperature is set to Level 1 for energy saving.
(Note: If the seat temperature before energy saving is neutral, then it will be neutral as well.)

Remark:

Energy saving mode will be suspended and the product will enter functional mode if the seat is used. The seat starts to heat immediately (without turning off the seat temperature), and the energy saving mode is restored once the seat is no longer being used.

Usage Instruction

Water temperature adjustment



Short press "💧" button to adjust the water temperature between 0-5 level. The indicator light is on showing current water temperature level. When the indicator is off, the temperature is at level 0 (room temperature).



Seat temperature adjustment



Short press "🪑" button to adjust the seat temperature between 0-5 level. The indicator light is on showing current seat temperature level. When the indicator is off, the temperature is at level 0 (room temperature).



Drying air speed adjustment



- ① Under drying, press "🌀" button to switch the wind speed gear, and the gear adjustment will be cycled from 1-3 gears.
- ② Long press the "🌀" button to turn on/off the drying moving function.

Full flush



- Short press "💧" button, the toilet starts half flushing.
- Short press "💧" button, the toilet starts full flushing.
- Long press "💧" button to turn on/off auto flush function.





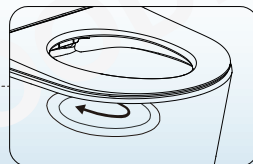



When the auto flush function is turned on, toilet will automatically flush after detecting user leaving the seat.

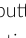

Usage Instruction

Foam setting



- ① Short press "  " button to activate the foam shield function.
 - ② Long press "  " button to turn on pumping quickly until the foam comes out and then release it. (Note: This operation is only used when the toilet has just been installed or the foam agent is used up, and the foam agent is added again. The use of the rest of the time will cause foam agent to be wasted.)
 - ③ Press "  " button first, then press "  " button to turn on the automatic foaming function, and the buzzer will beep once.
 - ④ Press "  " button again and press "  " button to turn off the automatic foaming function, and the buzzer will beep twice.
- After the automatic foaming function is on, when it is detected that the user is sitting, the foam shield function will be turned on automatically. (The automatic foaming function is turned off by default)

Auto lid open/close



Short press "  " button, open or close the lid.

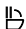

Short press "  " button, open or close the seat.

Long press "  " button to turn on/off auto lid open/close function.

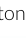

User code

- Radio frequency remote control

- ① Shut off the power supply of toilet
- ② Press and hold "  " button, then press "  " button, the indicator light will flash.
- ③ Re-connect the power plug and press "reset" button.
- ④ The indicator stops flashing and stays on for 2 seconds, indicating that the remote control and the toilet are matched successfully. It beeps once when the self-inspection completes. Then the remote control is ready for use.

Usage Instruction

Other operations

Quiet mode

- Press and hold the "■" button and press the "👤" button to turn on/off quiet mode.

Auto deodorization

- Press and hold "■" button and press "🌀" button to turn on/off auto deodorization function.
The deodorization function will be automatically turned on when the user is seated, and will stop after user leaves. Under drying, deodorization will stop. (This button combination is only applicable to toilets with auto deodorization function, and the auto deodorization function is turned on by default when the power is on every time.)

Night light

- Night light adjustment: Long press "🕯" button to turn on/off night light.
- Intelligent mode: Long press "🕯" button to enter into intelligent mode (Night light will be on or off depending on the surrounding light.). If the product is on intelligent mode, long press "🕯" button to exit intelligent mode. (Factory setting: intelligent mode)

Automatic pre-wetting function

- Press and hold "■" button and press "💧" button to turn on or off automatic pre-wetting function. After the automatic pre-wetting function is turned on, the pre-wetting function will be performed when the user is detected to be seated. (Only for the toilet with automatic pre-wetting function.)

Foot sensor function

- Long press "👤" button to turn on/off foot sensor function. Foot sensor is deactivated when the user is seated. (Only for the toilet with foot sensor function.)

Four Seasons Temperature Sensing function

- ① Long press "📺" button to activate the Four Seasons Temperature Sensing function, indicated by a single beep. Once activated, the unit will intelligently adjust the water temperature, air temperature, and seat temperature based on the external environment.
- ② Long press "📺" button again to deactivate the Four Seasons Temperature Sensing function, indicated by two beeps. (The Four Seasons Temperature Sensing function is set to off by default and needs to be activated for first-time use.)

Remark:

- In case of power cut during nozzle spraying, the wand cannot be retracted, please wait until the power is restored. In case of a power cut for a long period, please push the wand softly back by hand. Do not push hard, to avoid damage to wand and electrical machine.

IMPORTANT!

- DO NOT USE:** Abrasive cleaners such as: acid, ammonia, bleach, and similar solutions. Use of such solutions may cause corrosion, finish peeling, and/or dull the surface.
- DO NOT USE:** Abrasive sponges or cloth. Never use steel, wool, or wired brushes that will permanently scratch the surface.

Retain these installation instructions for future reference!

Thank you for using WOODBRIDGE products!

WOODBRIDGE®

California (Norwalk) Distribution Center
15600 Blackburn Ave, Norwalk, CA 90650

New Jersey (Somerset) Distribution Center
635 Pierce St, Somerset, NJ 08873

Florida (Orlando) Distribution Center
13645 S Orange Ave, Orlando, FL 32824

Canada (Ontario) Distribution Center
615 Orwell Street, Unit B, Mississauga, ON L5A2W4, Canada



Please don't hesitate to contact us if you have any questions or concerns.

Customer Service Phone: 562-229-0088. (Monday - Friday 9 AM - 5 PM Pacific Standard Time)

Or Email: help@woodbridgebath.com