

INSTALLATION AND CARE GUIDE

ELECTRONIC BIDET TOILET

WOODBIDGE®

Model: **CHT002**

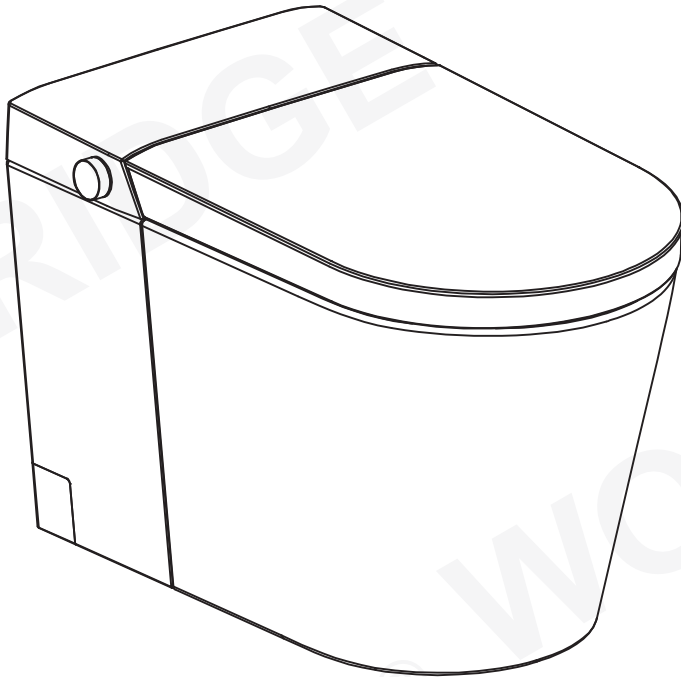

**SCAN
ME**



**For
Product Support
and Warranty**

Compliance with the following codes & standards:

- 2015 Uniform Plumbing Code® (UPC)
- 2018 International Plumbing Code® (IPC)
- 2018 International Residential Code® (IRC)
- ASME A112.4.2/CSA B45.16-2015 (R2020) Personal Hygiene Devices for Water Closet
- ASME A112.19.2/CSA B45.1-2018 (R2023)-Ceramic Plumbing Fixtures

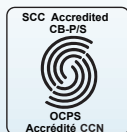

**PREFERRED
EDUCATION
PROVIDER**



READ ALL INSTRUCTIONS BEFORE UNPACKING THE PRODUCT

INSTRUCTIONS THAT, IF IGNORED COULD RESULT IN DEATH OR SERIOUS INJURY CAUSED BY INCORRECT HANDLING OR INSTALLATION OF THE PRODUCT. THESE INSTRUCTIONS MUST BE OBSERVED FOR SAFE INSTALLATION.

CAUTION!



**TWO PERSON
LIFT REQUIRED**

**2 PEOPLE ARE REQUIRED TO LIFT AND COMPLETE
INSTALLATION OF THIS PRODUCT**



**INSTALLATION OF THIS PRODUCT BY AN
INEXPERIENCED INSTALLER MAY RESULT
PERSONAL INJURY OR DEATH!**



We reserve the right to change, update, modify, alter, redesign this manual/product or its policies without prior notice!

We shall not be liable for any injuries or property damages in connection with this product during installation or use of this product!

- This product must be installed by a fully insured and licensed plumber only. Installation of any our products by anyone other than fully insured and licensed plumber shall void limited warranty. We recommend that such licensed plumber have experience in the installation of products.
- Limited warranty is void on any commercial installation.
- We are not responsible for local code compliance for this product. Building and plumbing codes may vary from state-to-state in accordance to your location. We are not responsible for providing any compliance certifications.
- Under no circumstances we shall not be liable for any and all incidental damages sustained in connection with this product. Neither manufacturer, nor distributor, nor retailer is responsible for water damage or flood caused due to use of this product.
- Under no circumstances We shall not be liable for any and all fees, cost of installation/reinstallation/removal, subsequent damage or transportation in case of the product defect.

SAFETY INSTRUCTIONS

Read all instructions carefully before installation and use. Failure to follow these safety precautions may result in electric shock, fire, property damage, or serious injury.

Electrical Safety

- This product must be connected to a dedicated 110-120V, 50Hz- 60Hz GFCI-protected outlet with a minimum 10A load.
- Do not use extension cords, splitters, or loose sockets.
- Ensure the outlet is properly grounded. If unsure, contact a qualified electrician.
- Unplug immediately if the product falls into water or becomes wet.
- Never open, modify, or repair this product yourself. Contact a licensed service technician.
- Always unplug before cleaning or servicing.
- Do not use the unit during a thunderstorm.
- Keep the power plug and outlet dry at all times.

Water & Installation Safety

- Install the toilet in a dry, indoor location. Do not expose to rain or standing water.
- Use only tap water within 41°F-104°F (5°C-40°C).
- Do not connect to a hot-water line or water heater outlet.
- Avoid water temperatures below 32°F (0°C). Drain the tank and hose if freezing may occur.
- Use only new hoses and fittings provided with the product. Do not reuse old parts.
- Do not embed the toilet base in cement or mortar; it may crack the ceramic body.
- Do not install near flammable materials or heat sources.

Usage & Maintenance Safety

- Do not stand, sit, or place heavy objects on the lid or seat.
- Do not allow children to play with the product.
- People with limited mobility, sensory, or mental ability should use only under supervision.
- Avoid using harsh chemicals, solvents, or abrasives for cleaning. Use a soft cloth and mild, non-corrosive cleaner.
- Do not spray or pour water or detergent directly onto the unit.
- If any function fails or an abnormal smell/sound occurs, stop use and unplug immediately.
- Disconnect the power and water supply if not used for a long period.

Important

- Installation must be completed by a licensed and insured plumber.
- Improper installation or use will void the warranty.
- WOODBRIDGE is not responsible for injuries or damage resulting from improper installation or use.

TECHNICAL SPECIFICATIONS

Product Name	Smart Toilet
Rated Voltage	110-120V
Rated Frequency	60Hz
Rated Power	45W
Flush Volume	1.28GPF(4.8LPF)
Waterproof Level	IPX4
Heated Seat Temperature	4 levels(Room Temperature to 105°F)
Operating Temperature	41-104°F
Supply Water Pressure	26-73 PSI(0.18MPa-0.5MPa)
Codes/Standards	ASME A112.19.2-2018/CSA B45.1-18 ASME A112.4.2-2021/CSA B45.16:21

- No further notice will be provided if any technical specifications change due to product improvements or technical updates. All actual technical specifications are subject to the final product.

PACKING LIST

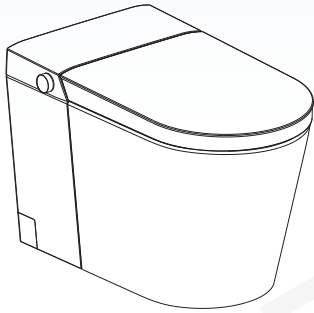

Main Unit



Flow Regulator

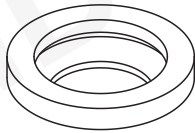

Wax Ring



9V Battery Box (Battery excluded)



1/2 inch-to-3/4
inch Adapter



1/2 inch-to-9/16
inch Adapter

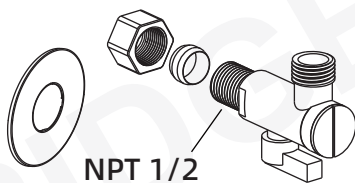

Angle Valve

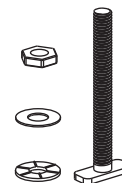

T-bolts

Note: Flange plate is not included and must be purchased separately.

PART LIST

Left Side

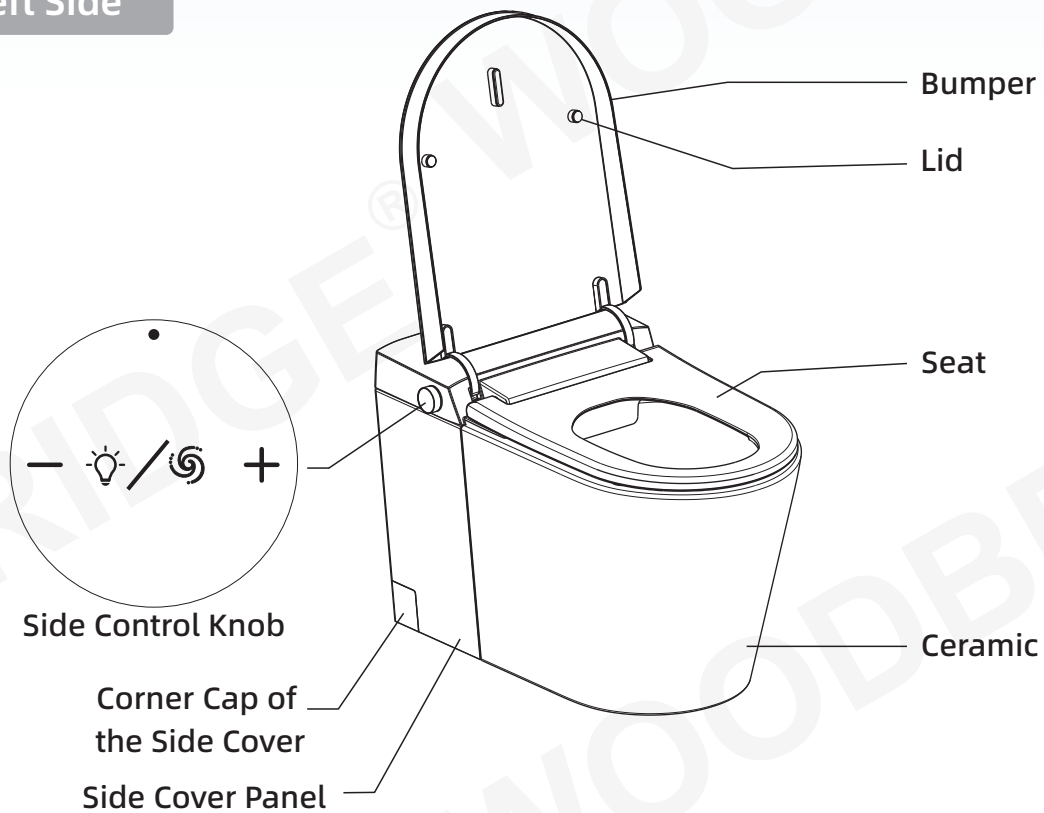

Right Side

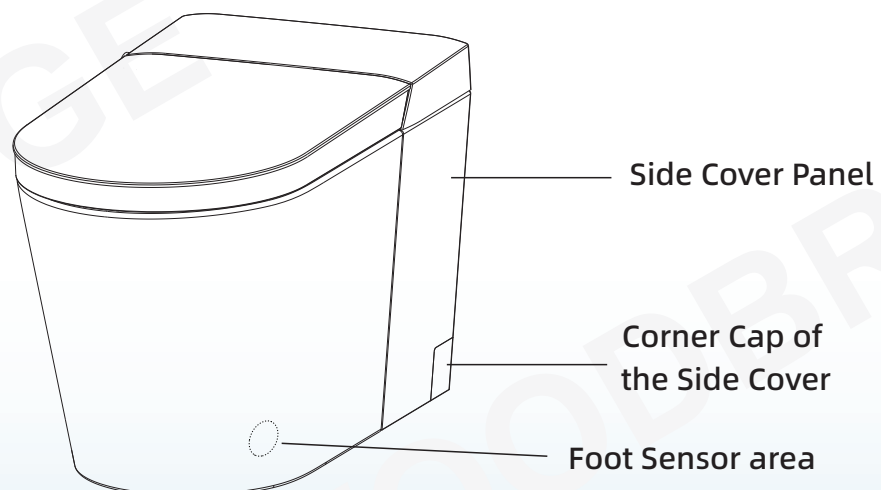

- The product drawing is for reference only. We reserve the right to modify the product's appearance. In case of any changes, the actual product shall prevail.

DIMENSIONS

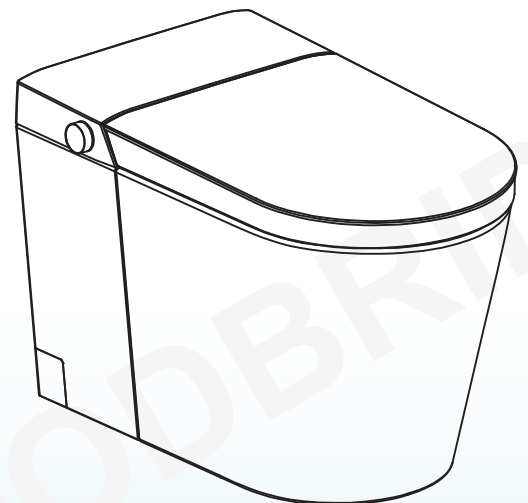
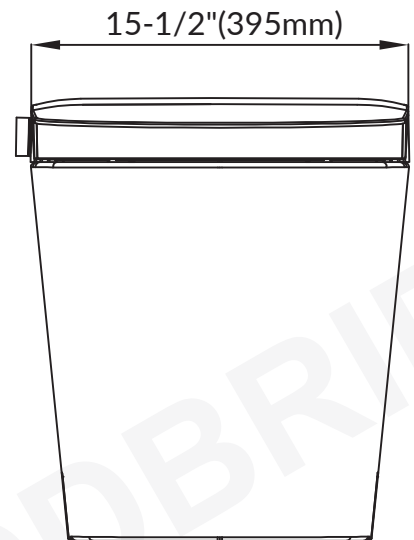
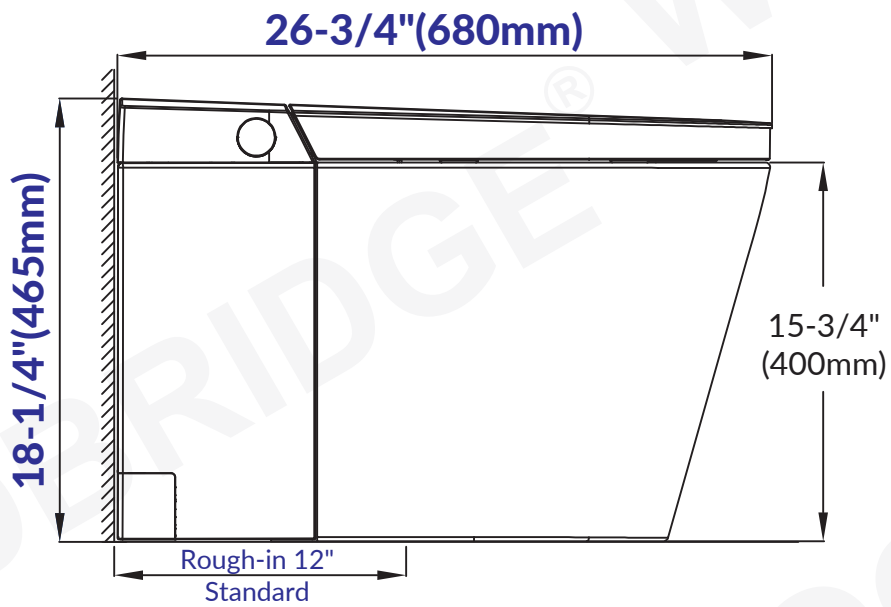

TOILET INSTALLATION

Required Tools:



Screwdriver



Tape measure



Wrench



Caulking gun



Marker



Electric drill

Water and Power External Installation Dimension Diagram:

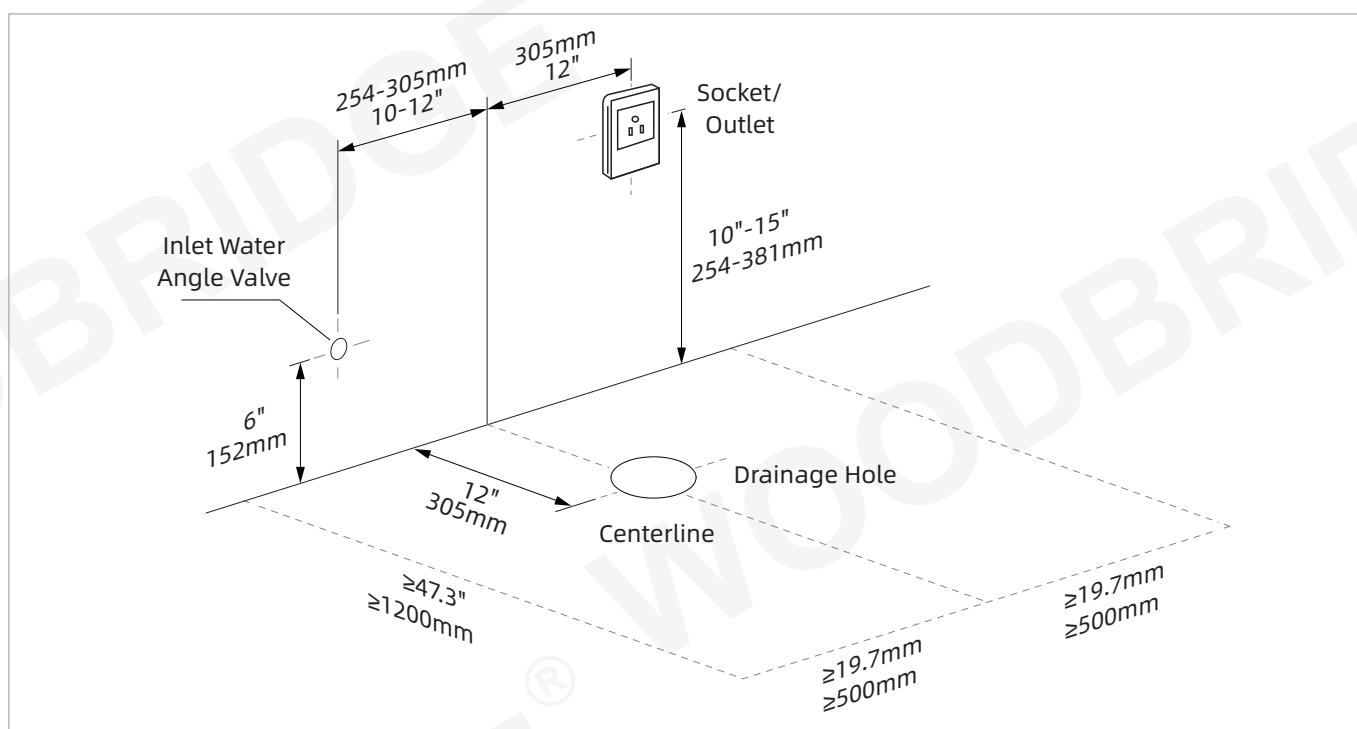

Water and Power Internal Installation Dimension Diagram:

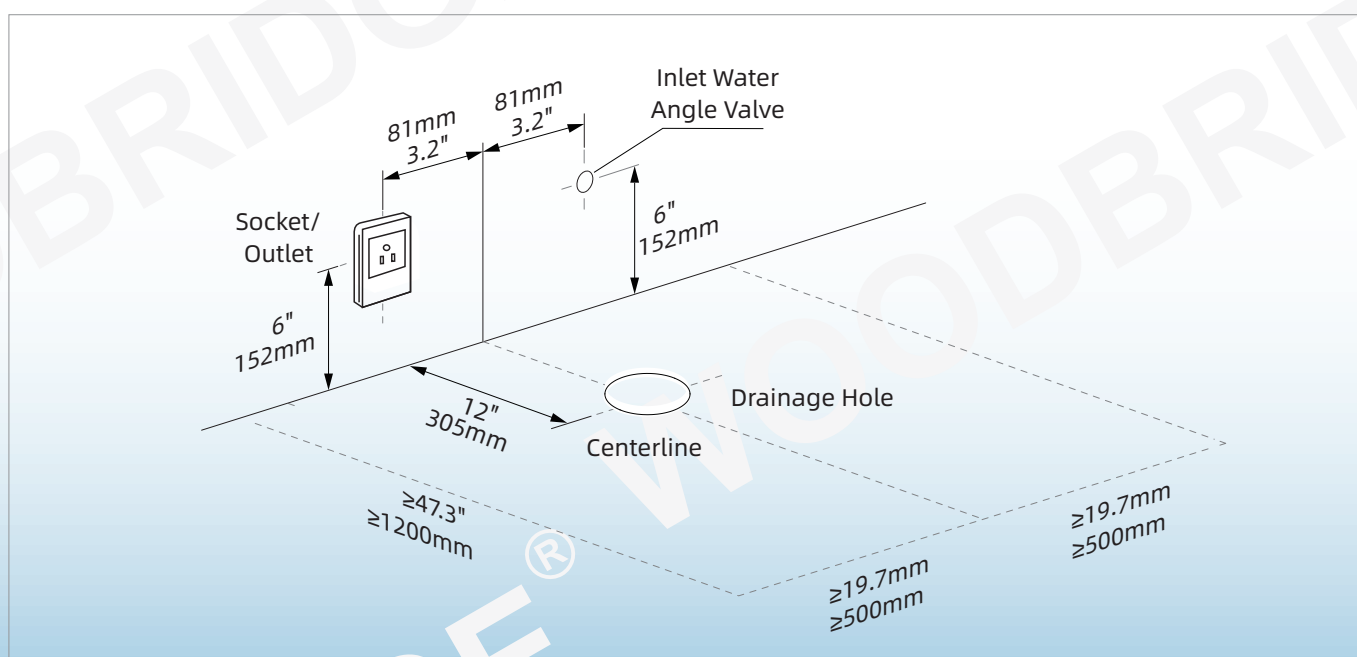

TOILET INSTALLATION

Installation Steps:

- 1. For a newly installed toilet in the bathroom, a flange plate needs to be added. (Flange plate is not included and installer has to purchase it for proper installation.)**
 - Place the flange plate into the drainage hole, aligning the arrow on the flange plate with the dashed line on the vertical wall. The center of the flange must align with the center line.
 - Use a marker to indicate the positions of the four installation holes on the flange plate.
 - Use a power drill to create four $\Phi 6\text{mm}$ installation holes on the flange plate. Insert four corresponding plastic anchors.
 - Secure the flange plate in place using the provided four screws.

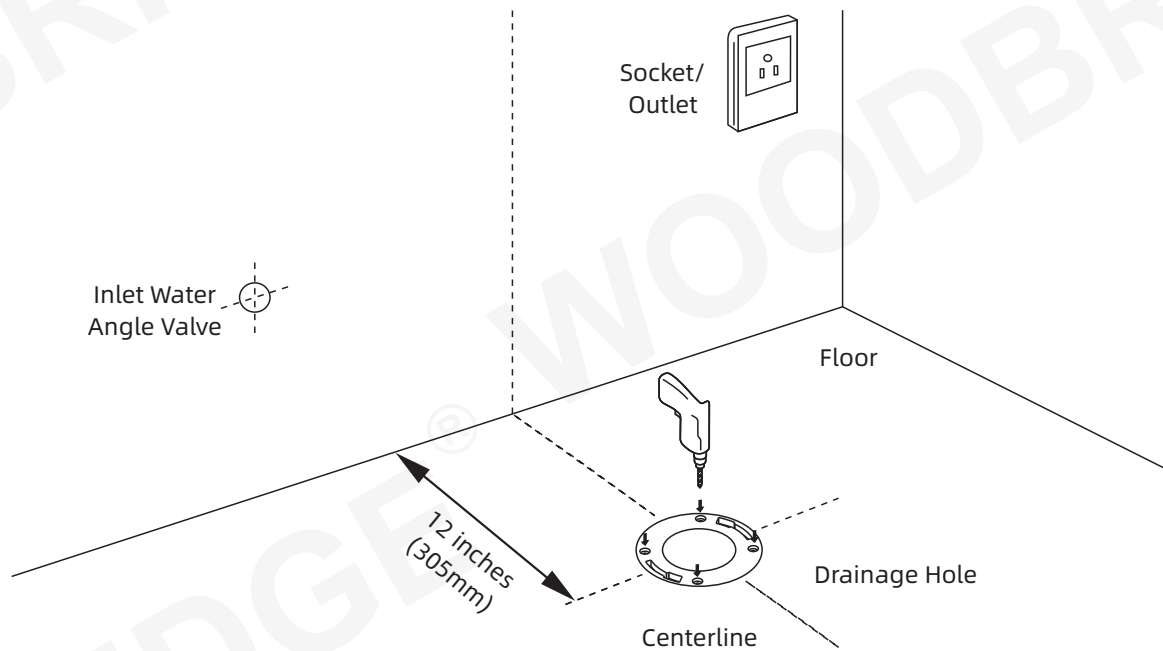

2. Install the floor bolts

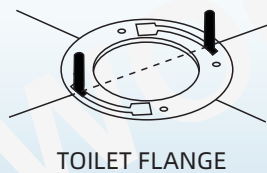
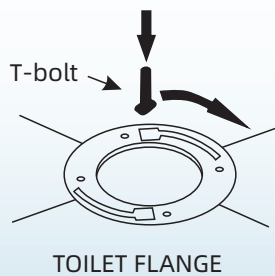

Note: The two screws and the center of the flange must be in a straight line

TOILET INSTALLATION

3. Install angle valve

■ 3.1 Installation Method 1:

3.1.1 Insert the water-saving insert and flat gasket into the 1/2 inch-to-3/4 inch adapter.

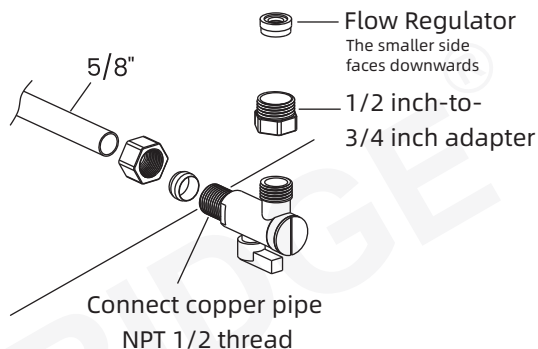

3.1.2 Screw the 1/2 inch to 3/4 inch connector into the angle valve and connect the angle valve to the copper pipe.

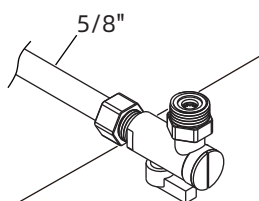

■ 3.2 Installation Method 2:

3.2.1 Insert the water-saving insert and flat gasket into the 1/2 inch-to-3/4 inch adapter.

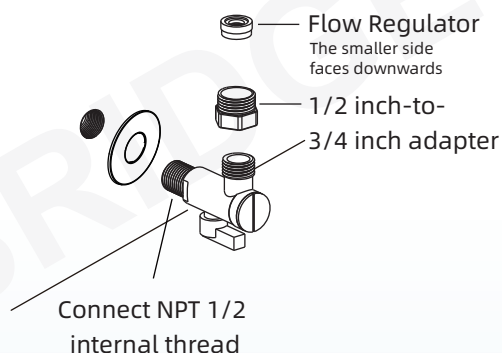

3.2.2 Screw the 1/2 inch to 3/4 inch connector into the angle valve, and then screw the angle valve into the water inlet.

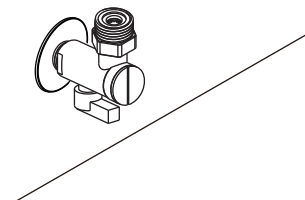

■ 3.3 Installation Method 3:

3.3.1 Wrap sealing tape around the NPT 9/16 thread of the valve and screw the end of NPT 9/16 onto the valve.

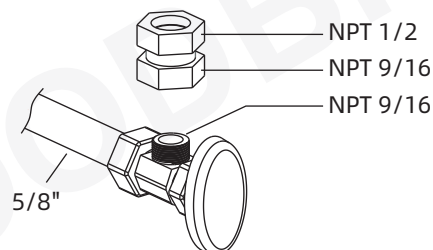

3.3.2 Remove the copper sleeve and nut from the NPT 1/2 valve.

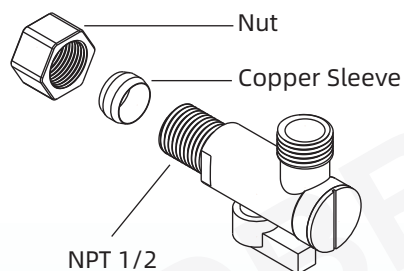

TOILET INSTALLATION

3.3.3 Wrap sealing tape around the NPT 1/2 thread of the valve, and then tighten the valve joint NPT 1/2 location.

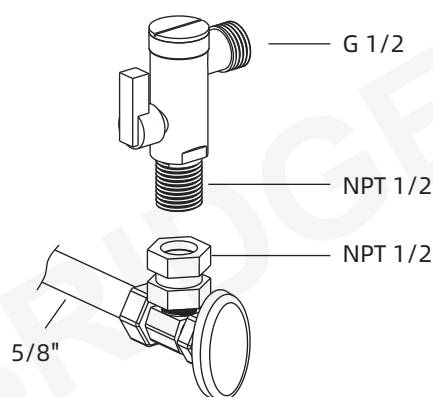

3.3.4 Twist the G 1/2-G3/4 variable diameter joint G 1/2 end onto the valve G 1/2. Then place the water-saving device into the variable diameter joint G3/4.

The smaller side faces downwards
Flow Regulator

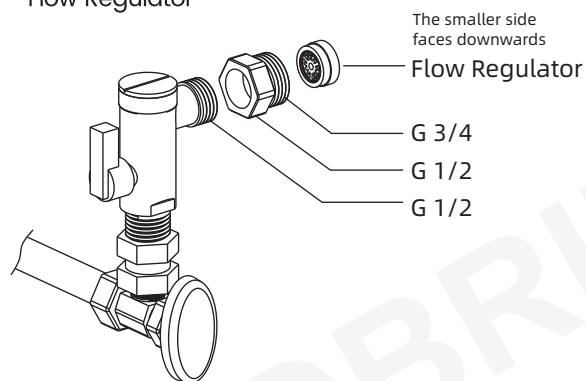

4. Install the wax ring

Put the wax ring on the flange

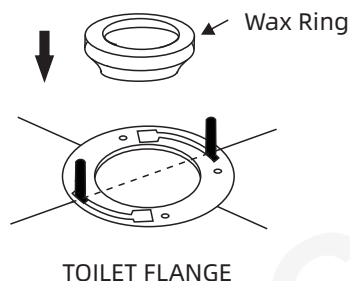

5. Toilet Installation

Remove the side cover panels from both sides of the ceramic base. Carefully lower the toilet onto the flange and press firmly to secure it.

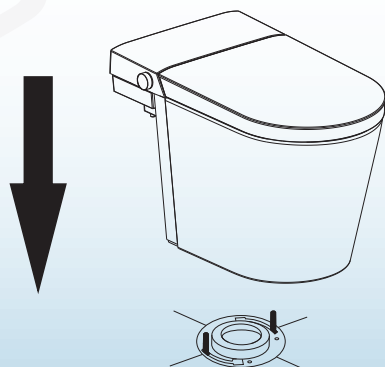

Place the washer and nut onto the T-bolt screw, then tighten securely.

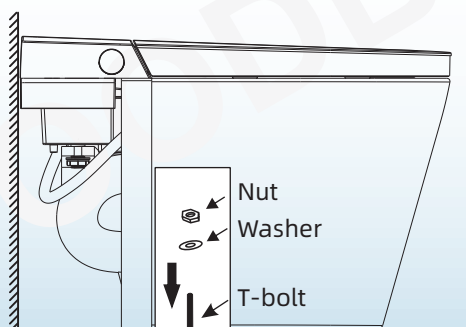

TOILET INSTALLATION

6. Connect the Backup Flush Battery Box

Open the battery box, insert one 9V battery, locate the battery connector at the rear of the toilet, and connect it to the battery box.

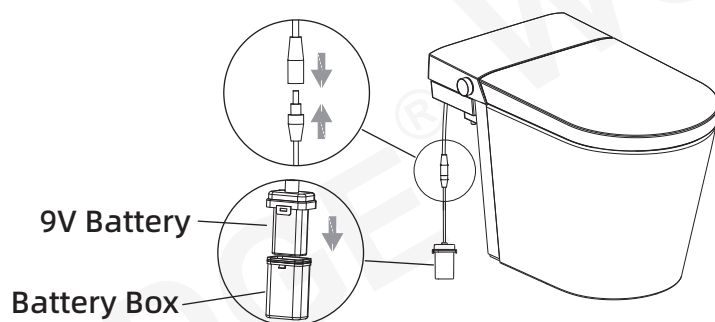

7. Connect Water Supply and Power

- Plug the power cord into the electrical outlet.
- Connect the water inlet hose to the angle valve and turn on the water supply valve.

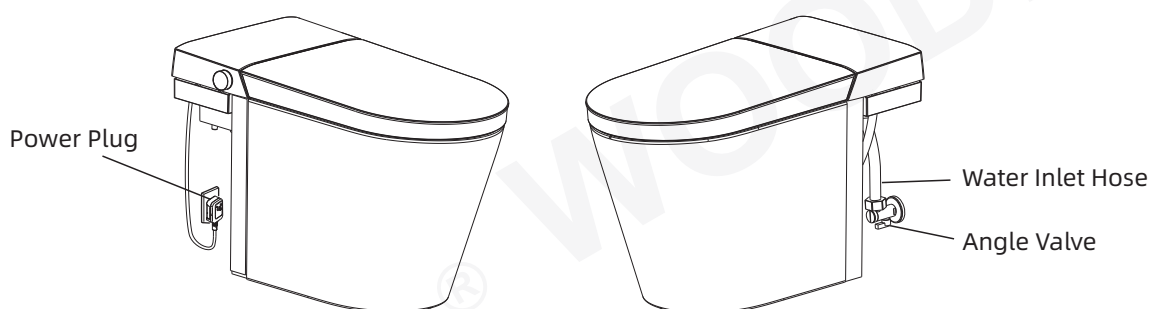

8. Install the Side Cover Panels

- For external water and power connections, remove the corner caps of both side cover panels. Route the water inlet hose and power cord through the two notches.
- For internal water and power connections, skip this step.

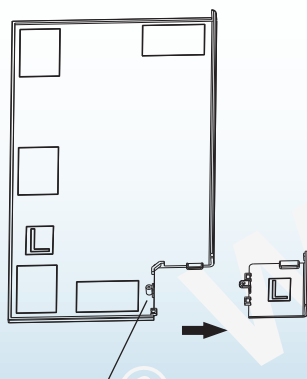

Use a Phillips screwdriver to remove the screws.

TOILET INSTALLATION

9. Test all functions and ensure the toilet is securely fixed.

- Press the control knob briefly to test whether the flushing function works properly and check for any water leakage around the ceramic base.
- Apply silicone sealant evenly along the bottom edge of the ceramic using a sealant gun, then reinstall the side covers.
- Please allow 24 hours after installation before using the product.

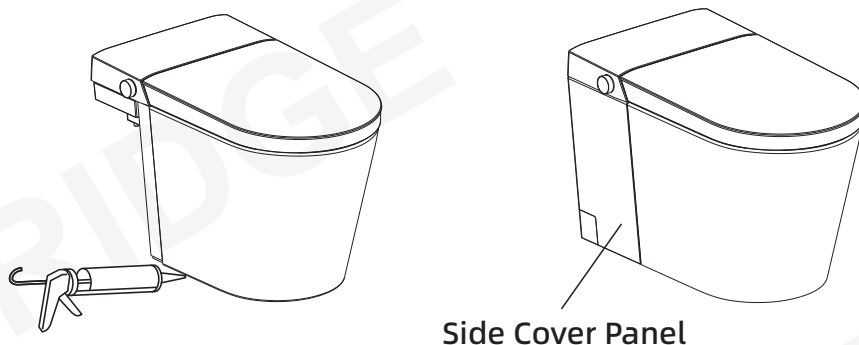

BEFORE USING

1. Turn on the angle valve

- Check the threaded connection to ensure there are no leaks.
- Unscrew the angle valve counterclockwise to fully open it.

(Tips: When opening the angle valve for the first time, the handle may require more torque.)

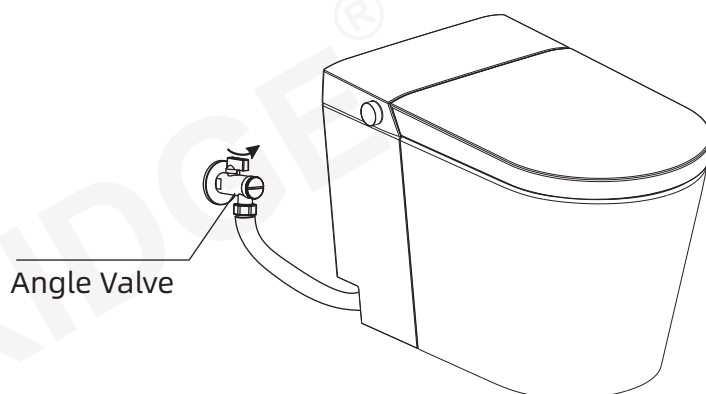

2. Power Connection

Insert the leakage protection plug into the power socket. Press the reset switch. The plug indicator lights up, indicating that the power is on.

Tips:

- Before usage, press the electric leakage test button. The reset switch should pop up, indicating that the leakage protection function is normal.
- Press the **TEST** button (then the **RESET** button) once a month to ensure proper operation.

Note: Only applicable for models equipped with a leakage protection plug. Please refer to the actual product for details.

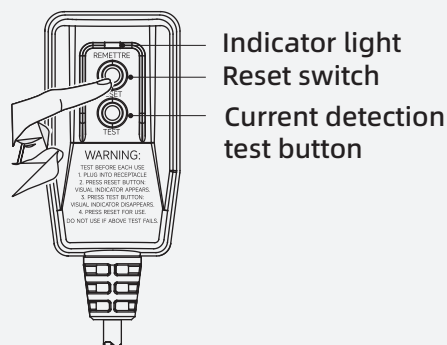

3. Self-inspection

- The main unit buzzer rings “beep” .
- After another “beep” from the buzzer, self-inspection is complete.
- Proceed to normal function mode for regular usage.

FUNCTION DESCRIPTION

Automatic Flip (toilet) Seat Cover

(This feature is unique to the automatic flip toilet)

- Automatic flip (toilet) seat cover open and close the seat cover by identifying the proximity/ presence/ departure of the human body.
 - When the human body is approximately 30-60cm away from the toilet, the cover will automatically open.
 - When the cover is opened, it will automatically close 30 seconds after the human body departs.
 - When the seat is lifted, both the seat and the toilet cover will automatically close and initiate a water flush upon the departure of the human body.
 - If the flushing function has already been activated during use, no additional flushing will occur after the cover is closed.
-

Foot-sensing lid/seat control

(This function is available only for models with automatic lid opening)

- When the lid is closed, extending a foot near the sensor area will open the lid automatically;
 - When the seat is closed, extend your foot towards the sensing area, it will automatically open the seat;
 - When the seat is open and a person stays in front of the toilet for less than 7 seconds, extending a foot near the sensor area will close the seat only;
 - When the seat is open and a person stays in front of the toilet for more than 7 seconds, extending a foot near the sensor area will close the seat and lid, and then flush automatically.
-

Automatic Flush After Leaving

When a user is seated more than five seconds, it will automatically flush after leaving the seat.

Power Outage Flushing

The toilet is equipped with a backup battery. In the event of a power outage, short press the knob to activate the flushing function.

FUNCTION DESCRIPTION

Energy Saving Mode

When the intelligent toilet is not used for 1 hour, it will automatically enter energy-saving mode, and the seat temperature will automatically adjust to 91°F, entering a low-temperature setting. Upon being seated, it will reheat to the preset temperature.

Pre-Flush (Bowl-Rinsing) Function

When the user sits on the seat, the toilet automatically activates the ceramic bowl-rinsing function, performing a full pre-flush around the bowl.

FUNCTION DESCRIPTION

Control Knob:

There are 4 functions of the side control knob: **[Flush]**, **[Seat temperature adjustment]**, **[Stop]**, **[Night light]**.

- Rotate the knob clockwise to increase the seat temperature.
- Rotate the knob counterclockwise to decrease the seat temperature.
- Press the knob to flush.
- Press and hold the knob for 3 seconds to power on/off the toilet.
- Rotate the knob clockwise for 3 seconds to turn on/off the night light.

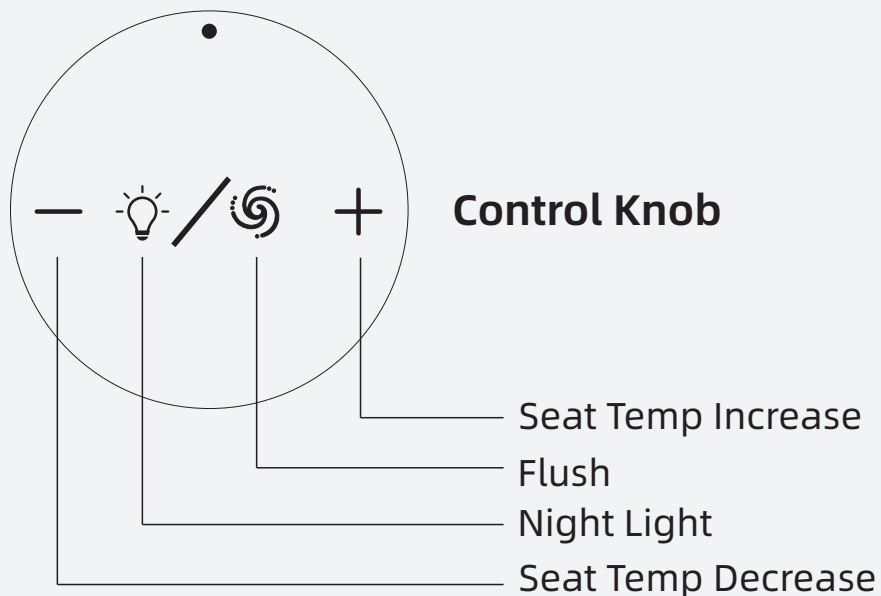

*The above is for reference only. Please select the corresponding function description based on the actual toilet model. ®

DAILY MAINTENANCE

Main unit care and maintenance

1. Turn off power supply before performing maintenance.

2. Wipe stains with a soft damp cloth.



3. After cleaning, reconnect the toilet to the power supply.

Maintenance of inlet filter screen

Maintenance is required when the system is under normal water pressure but experiencing poor flush performance.

1. Turn off power and the angle valve.

2. Unscrew angle valve nut.

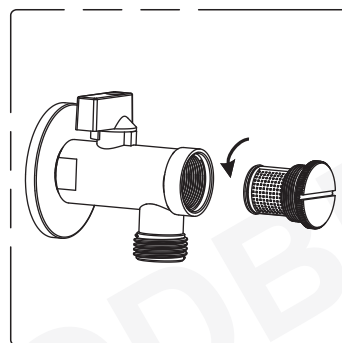

3. Use a brush to clean inlet filter screen.

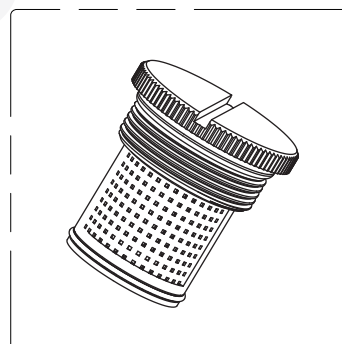

4. Reinstall inlet filter screen.

5. Turn on the angle valve and reconnect the power. The toilet will return to normal operation after self-inspection.

TROUBLESHOOTING GUIDE

Problem	Cause	Solution
Low seat temperature	The seat temperature is set to the normal temperature setting	Reset the seat temperature
Toilet leaking	Close the angle valve, inspect all water pipes, and contact a professional.	
 Caution	If the problems cannot be resolved using the methods above, please turn off the power and the angle valve, then contact service providers for maintenance.	
	If the leakage circuit breaker frequently trips, indicating electrical leakage, turn off the power and the angle valve, then contact the service provider for maintenance.	

Woodbridge warrants the following products as listed in below to be free from defects in material and workmanship, subjected to the limitations set forth in this limited warranty.

- Bathtub, Whirlpool/Air Bubble Massage Tub, Cold Plunge, Wooden Tub: 1 Year limited to be free of defects in material and workmanship.
- Sauna room and Sauna Tent: 1 Year limited to be free of defects in material and workmanship.
- Toilet and Bidet: 1 Year limited to be free of defects in material and workmanship.
- Faucet: 1 Year limited to be free of defects in material and workmanship.
- Vanity and Vanity Top: 1 Year limited to be free of defects in material and workmanship.
- Granite, Marble, Engineered Quartz Vanity Top: 1 Year limited to be free of defects in material and workmanship.
- Medicine Cabinet, LED Mirror: 1 Year limited to be free of defects in material and workmanship.
- Stainless Steel Sink: 1 Year limited to be free of defects in material and workmanship.
- Solid Surface Shower Wall Panel, SMC Shower Base: 10 Years limited warranty to be free from material defects.
- Drain Cover and PVC Drain: 1 Year limited to be free of defects in material and workmanship.
- Shower Door: Lifetime warranty on glass components and 1 Year limited on other hardware.

This limited warranty is non-transferable and only applies to products purchased and installed in the United States and Canada

This limited warranty excludes all industrial, commercial and business usage. Proof of purchase (original sales receipt) from the original purchaser, Description and pictures of defect, model number or model description must be provided to Woodbridge Bath for all warranty claims and Woodbridge Bath IS NOT responsible for labor cost, removal or installation costs.

This limited warranty shall not apply to goods which have been subject to accident, negligence, improper installation, product abuse, product misuse, or use of cleaners containing abrasives, alcohol or other organic solvents, whether performed by a contractor, service company, or yourself, are excluded from this warranty.

This warranty does not cover surface damaged caused by use of chemicals that break through or dissolve the surface finish or damage caused by the accidental dropping of sharp or heavy objects. Improper care and use of abrasive cleaners and will void the warranty.

During this limited warranty period if a malfunction occurs and after inspection it is determined that a defect developed during normal use, Woodbridge reserves the right to take any of the following actions at its discretion:

- (1) repair or replace the defective part(s) or product(s) at cost**
- (2) issue a refund of the original purchase price of the product(s) (Valid within 30 days from the date of purchase)**
- (3) issue a credit to be applied toward the purchase of a new product. Shipping or delivery charges may apply. Whether such charges are required, and the amount and conditions under which they apply, shall be determined solely at the discretion of Woodbridge.**

Caution:
NEVER use cleaners containing abrasives, ammonia, bleach, acids, waxes, alcohol, solvents or other products not recommended for chrome finishes. Doing so will void the warranty.

Woodbridge products should be installed by a fully insured and licensed contractor only. Installation by anyone other than fully insured and licensed contractor will void this limited warranty.

RESPONSIBILITIES OF OTHERS

Inspecting the unit prior to installation is the responsibility of the installer or building contractor who acts on behalf of the user. They are responsible for ensuring the unit is free of defect or damage. Notices are placed on the unit and on the shipping carton advising the installer of this responsibility. In the event of a problem, the unit must not be installed. Woodbridge is not responsible for failures or damage that could have been discovered, repaired, or avoided by proper inspection and testing prior to installation.

Damage occurring in transit is the responsibility of the carrier. The user or installer MUST open the crate and inspect the unit for damage when it is delivered. If damage is discovered, it must be reported immediately to the seller and the carrier in writing, and an inspection requested. Failure of the carrier to respond should be reported to the seller and the carrier. Your freight claims should be filed promptly thereafter.

This limited warranty does not cover any liability for consequential or incidental damages, all of which are hereby expressly disclaimed, or the extension beyond the duration of this limited warranty of any implied limited warranties, including those of merchantability or fitness for an intended purpose.

DISCLAIMER

Except as expressly provided, there shall be no warranty or obligation, express or implied, oral or statutory. No dealer or other person has the authority to make any warranties or representations concerning or its products. In no event shall be held responsible for any such warranties or representations.

Some states/provinces do not allow limitations on how long an implied warranty lasts, or the exclusion on limitation of special, incidental or consequential damages, so these limitations and exclusions may not apply to you. This warranty gives you specific legal rights, you may also have other rights which vary from state/province to state/province.

To obtain warranty and replacement parts, please send e-mail to help@woodbridgebath.com with the original receipt information, Woodbridge will determine whether to repair or replace your product, issue a refund or issue a credit.

IMPORTANT!

DO NOT USE: Abrasive cleaners such as: acid, ammonia, bleach, and similar solutions. Use of such solutions may cause corrosion, finish peeling, and/or dull the surface.

DO NOT USE: Abrasive sponges or cloth. Never use steel, wool, or wired brushes that will permanently scratch the surface.

Retain these installation instructions for future reference!

Thank you for using WOODBRIDGE products!

WOODBRIDGE®

California (Norwalk) Centre de distribution
15600 Blackburn Ave, Norwalk, CA 90650

New Jersey (Somerset) Centre de distribution
635 Pierce St, Somerset, NJ 08873

Floride (Orlando) Centre de distribution
13645 S Orange Ave, Orlando, FL 32824

Canada (Ontario) Centre de distribution
615 Orwell Street, Unit C, Mississauga, ON L5A2W4, Canada

**SCAN
ME**

**For
Product Support
and Warranty**



Please don't hesitate to contact us if you have any questions or concerns.

Customer Service Phone: 562-229-0088. (Monday - Friday 9 AM - 5 PM Pacific Standard Time)

Or Email: help@woodbridgebath.com